

Apartment Payment Schedule

TYPE B 2 Bed Apartment (1390 sq. ft.)

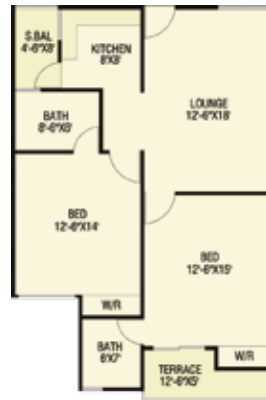

		Pre-launch	After launch
Total price		Rs. 9,313,000	Rs.9,730,000
Down Payment	25%	Rs. 2,328,250	Rs.2,432,500
Quarterly Installment	15	Rs. 447,024	Rs.7,005,600
Monthly Installment	45	Rs. 149,008	Rs.6,705,360
Possession		Rs. 279,390.00	Rs. 291,900

TYPE C 1 Bed Apartment (950 sq. ft.)



		Pre-launch	After launch
Total price		Rs.6,365,000	Rs.6,650,000
Down Payment	25%	Rs.1,591,250	Rs.1,662,500
Quarterly Installment	15	Rs.305,520	Rs.4,788,000
Monthly Installment	45	Rs.101,840	Rs.4,582,800
Possession		Rs.190,950	Rs.190,950

Charges exclusive of apartment's Price :

Corner	5%
1st Floor	3%
2nd Floor	2%
6th Floor	3%
7th Floor	2%

Apartment Payment Schedule

TYPE A1

3 Bed Apartment (2000 sq. ft.)

Pre-launch

After launch



Total price			Rs.13,400,000	Rs.14,000,000
Down Payment	25%		Rs.3,350,000	Rs.3,500,000
Quarterly Installment	15	Rs.643,200	Rs.9,648,000	Rs.10,080,000
Monthly Installment	45	Rs. 214,400		
Possession			Rs.402,000	Rs.420,000

TYPE A

3 Bed Apartment (1900 Sq.Ft)

Pre-launch

After launch



Total price			Rs.12,730,000	Rs.13,300,000
Down Payment	25%		Rs.3,182,500	Rs.3,325,000
Quarterly Installment	15	Rs.611,040	Rs.9,165,600	Rs.9,576,000
Monthly Installment	45	Rs.203,680		
Possession			Rs.381,900.00	Rs.399,000

Charges exclusive of apartment's Price :

Corner	5%
1st Floor	3%
2nd Floor	2%
6th Floor	3%
7th Floor	2%